



TEMPE  
ARIZONA

ISPN2018  
April 10-14

## 11th Annual Psychopharmacology Institute Pre-Conference • April 10-11

Welcome to the 11th Annual ISPN Psychopharmacology Institute! The content has been carefully chosen based on feedback from ISPN members and from all the participants from previous ISPN Psychopharmacology Institutes. The Psychopharmacology Institute Pre-Conference planning committee members have worked diligently over the last year to respond to ideas for topic areas and recommended speakers. The current content is comprehensive and addresses patients across the lifespan. Some of this year's topics include treatment of ADHD, geriatric psychopharmacology, pharmacologic management during pregnancy and lactation, pediatric bipolar disorder, SPMI ongoing care, use of genetics to address COMT gene in ADHD, and Integrating Pharmacogenetics and Neurobiology in the care of difficult-to-treat adolescents.

The Susan McCabe Lectureship will be presented by Dr. Evelyn Parrish, who will discuss Delirium Superimposed on Dementia: Treatment Challenges and Opportunities. Our closing plenary will be presented by Michael Tremko, APRN, on Orthomolecular Psychiatry.

During the Institute we have an educational grant symposium, "Clinical Convergence™: Optimizing the Diagnosis and Management of Pediatric Bipolar Disorder," and a sponsored Product Theater Luncheon, "Explore an Option for Adult Patients With Schizophrenia Who May Need a Change in Treatment."

A general session focusing on Current Issues in Prescribing Controlled Substances: Curbside Consult (Facts, Fears, and Fallacies) will be presented on Wednesday. We hope you will take the opportunity to be actively involved in the learning process by sharing any concerns or issues you have in the prescribing and management of patients on controlled substances.

The Psychopharmacology Institute Pre-Conference is designed to be interactive and assist you in developing partnerships that will last far beyond the two days of the Institute. You will have opportunities to network with advanced practice colleagues, establish relationships, and interact with the presenters. We actively encourage our student participants to continue their course of education into real-time practice and establish connections with experienced prescribing APRNs. We hope you will join us in making this educational event a positive and productive learning experience.

Please take time to enjoy Tempe, and join us for the ISPN Annual Conference Opening Reception on Wednesday evening!

We look forward to seeing you in Tempe,

*Evelyn Parrish*

Evelyn Parrish, PhD, APRN, PMHCNS-BC, PMHNP-BC  
Co-Chair

*Debbie Thomas*

Debbie Thomas, EdD, APRN, PMHCNS-BC, PMHNP-BC, CMP  
Co-Chair

# TABLE OF CONTENTS

Abstract Reviewers.....3	Meeting Rooms.....4
Badges .....4	Mission and Practices .....8
Board of Directors and Leadership.....2	Nursing Contact Hours .....3
Business Meeting .....3	Objectives .....3
Call for 2019 Abstracts .....4	Planning Committee .....3
Care Room.....4	Program Schedule ..... 6 & 7
Disclosure to Participants .....4	Registration.....3
Evaluation Form .....3	Safety and Security.....8
Exhibitors.....5	Sponsor and Product Theater Ads .....11 & 12
Hotel Floor Plans.....10	Thank You to Sponsors and Exhibitors .....9

## GENERAL INFORMATION

### OFFICERS & DIRECTORS

#### *President*

Rene Love, PhD, DNP, PMHNP-BC, FNAP, FAANP

#### *President-Elect*

Steven Prymachuk, PhD, PGDipEd, RN (Mental Health),  
CPsychol, SFHEA

#### *Treasurer*

Helen Teresa "Trez" Buckland, PhD, MEd

#### *Past President*

Edilma L. Yearwood, PhD, PMHCNS, BC, FAAN

#### *Directors*

Ukamaka M. Oruche, PhD, RN, PMHCNS-BC, FAAN  
Sally Raphael, MS, APRN/PMH, FAAN

#### *Recording Secretary*

Andrea Kwasky, DNP, PMHNP-BC, PMHCNS-BC

### ISPN FOUNDATION BOARD

#### *President*

Peggy Dulaney, MSN, RN

#### *Secretary*

Caroline McKinnon, PhD, PMHCNS-BC

#### *Treasurer*

Judy Fry-McComish, PhD, RN, FAAN

#### *Directors*

Jim Kane, MN, RN, CNS, NEA-BC  
Irene Kim, DNP, PMHNP-BC, PMHCNS-BC  
Evelyn Parrish, PhD, APRN, PMHCNS-BC,  
PMHNP-BC  
Ann Roselle, MSN, ACNP-BC  
Sandra Thomas, PhD, RN, FAAN

## COMMITTEES

#### *Awards Committee Chair*

Rhonda Schwindt, DNP, RN, PMHNP/CNS-BC

#### *Communications Committee*

Caroline McKinnon, PhD, PMHCNS-BC, Co-Chair  
Steven Prymachuk, PhD, PGDipEd, RN (Mental Health),  
CPsychol, SFHEA, Co-Chair

#### *Conference Committee*

Amanda Baltierra, DNP, MPH, FNP-BC, PMHNP-BC, Chair  
Carla J. Groh, PhD, PMHNP-BC, FAAN, Co-Chair

#### *Psychopharmacology Institute Planning Committee*

Evelyn Parrish, PhD, APRN, PMHCNS-BC, PMHNP-BC, Co-Chair  
Debbie Thomas, EdD, APRN, PMHCNS-BC, PMHNP-BC, CMP,  
Co-Chair

#### *Diversity and Equity Committee Chair*

Cheryl Woods Giscombe, PhD, PMHNP-BC

#### *Finance Committee Chair*

Helen Teresa "Trez" Buckland, PhD, MEd

#### *Marketing and Development Committee Chair*

Caroline McKinnon, PhD, PMHCNS-BC

#### *Membership Committee Chair*

Marian Newton, PhD, PMHNP, PMHCNS

#### *Nominating Committee Chair*

Edilma L. Yearwood, PhD, PMHCNS, BC, FAAN,  
ISPN Past President

#### *Website Management Committee Chair*

Kristina Stevens, MSN, PMH-APN, BC

**Newsletter Editor** Angela McNelis, PhD, RN, ANEF

**ISPN Executive Director** Kathy Kuehn



## Planning Committee and Abstract Reviewers

Evelyn Parrish, PhD, APRN, PMHCNS-BC, PMHNP-BC, Co-Chair  
 Debbie Thomas, EdD, APRN, PMHCNS/NP-BC, CMP, Co-Chair  
 Ann Marie Jones, MSN, PMHNP-BC  
 Susan Krupnick, MSN, PMHCNS-BC, ANP-BC, C-PREP  
 Marian Newton, PhD, RN, C  
 Karen Ragaisis, APRN, PMHNP-BC, PMHCNS-BC, CARN, MSN  
 Diane Snow, PhD, APRN, PMHNP-BC, FAANP, FIAAN  
 Victoria Soltis-Jarrett, PhD, PMHCNS-BC, PMHNP-BC  
 Sandra Tate, APN, CS  
 Roberta Thomas, PhD, PMHNP-BC  
 Linda Jo Volness, MS, CNS  
 Mary Weber, PhD, PMHNP-BC, FAANP

## Objectives

This course has been designed so that the participants will be able to:

- Identify the role of advanced practice nursing in providing psychopharmacological care
- Focus on a medication or psychopharmacological issue related to a specific population.

## 2018 Conference Highlights

### Symposium

Wednesday, April 11 • 10:00 a.m.-11:50 a.m.

Palm Ballroom BE

Clinical Convergence<sup>SM</sup>: Optimizing the Diagnosis and Management of Pediatric Bipolar Disorder

*Supported by an independent educational grant from Sunovion Pharmaceuticals Inc.*

### Product Theater Luncheon

Wednesday, April 11 • 11:50 a.m.-1:20 p.m.

Palm Ballroom AD

Explore an Option for Adult Patients With Schizophrenia Who May Need a Change in Treatment

Georgia Stevens, PhD, APRN, PMHCNS-BC

Director, P.A.L. Associates

*Sponsored by Otsuka America Pharmaceutical, Inc. & Lundbeck*

### ISPN 20th Anniversary Celebration

Immediately following the close of the Psychopharmacology Institute Pre-Conference: Join colleagues at Wednesday's Opening Reception, 6:30 p.m.-8:00 p.m., to recognize the 20th Anniversary of ISPN. A photo area will be available for you to capture memories. Selfies welcome!

### Mobile App

Download Guidebook and search for ISPN Conference. View the agenda, and plan your schedule from your phone or tablet.

## Registration

Psychopharmacology Institute registration will be open at the following times:

Tuesday, April 10..... 11:00 a.m.-2:00 p.m.

Wednesday, April 11 .....7:30 a.m.-7:00 p.m.

## ISPN Foundation

### Reception and Auction

**Thursday, April 12 • 6:15 p.m.-8:15 p.m.**

If you're attending the ISPN Annual Conference, don't miss the ISPN Foundation Reception and Auction features heavy hors d'oeuvres, a drink ticket, live and silent auction, and networking with colleagues in the mental health community. Proceeds fund research, wellness, and travel grants.

This year's theme is "The Butterfly Effect": Small efforts can have large effects—like your donations to support psychiatric-mental health nursing.

Join the fun under the stars on the Rooftop-Poolside (no swimwear allowed).

Pre-ordered tickets will be distributed at registration, where you also can check for ticket availability.

### Nursing Contact Hours

This continuing nursing education activity was approved by the Wisconsin Nurses Association, an accredited approver by the American Nurses Credentialing Center's Commission on Accreditation.

The ISPN 2018 Psychopharmacology Institute Pre-Conference has been awarded a maximum of **11.16** continuing education nursing contact hours through the Wisconsin Nurses Association Continuing Education Approval Program Committee. Contact hours are complimentary with your registration fee.

To obtain continuing education contact hours for attending the ISPN Psychopharmacology Institute, please complete the attendance form included in your packet of materials and evaluation form that will be sent to you via email. Please turn in one copy of the attendance form to the ISPN Registration Desk before you leave the conference.

The attendance form will serve as your contact hour certificate.

### Evaluation Form

The program evaluation form will be emailed to your email address on file. Please complete and submit your evaluation form electronically, once received. Your comments are valuable to ISPN and assist the Conference Committee in planning future conferences. If you have any questions about completing the evaluation form, please see the staff at the registration desk.

### Business Meeting

ISPN will hold its Annual Business Meeting on Saturday, April 14, starting at 8:15 a.m. in Palm Ballroom ABDE. All members are encouraged to join the Board of ISPN to discuss the Society's business report. Please be sure to attend! New this year: Tables will be labeled by geographical region. Look for the signs and network with your neighbors, starting at 7:45 a.m.

## GENERAL INFORMATION

### Care Room

Drop by for respite in the ISPN Care Room in the Wind Flower (2nd Floor) from 7:00 a.m.-6:00 p.m. daily.

### Meeting Rooms

Audible signals from pagers and cellular phones may be a distraction to the speaker as well as the audience. Please program these accordingly and take phone calls outside of the meeting rooms. Thank you!

### Internet

Complimentary basic high-speed wireless Internet is available in the meeting rooms for ISPN Annual Conference attendees. The hotel does have complimentary wireless Internet in the lobby and public areas. Guest room wireless fees apply.

### Badges

Your badge will admit you to all the Institute's educational sessions and the Opening Reception. It is recommended that you wear your badge at all times during the conference. Please remove your badge when you leave the hotel.

### Call for 2019 Abstracts

Information about the 2019 Call for Abstracts will be posted on the ISPN website.

### Disclosures Purpose Statement

Participants will be able to incorporate into their own practices the research and best practices learned from clinical experts about innovative practices and advocacy, from educators about new teaching pedagogies and interprofessional collaboration, and from researchers about evidence-based findings across a spectrum of psychiatric interests and mental health disorders across the lifespan and around the globe.

### Notice of Requirement for Successful Completion

To obtain continuing education contact hours for attending the ISPN Psychopharmacology Institute and Annual Conference, you must attend all sessions you are seeking credit for, complete and submit the attendance form included in your packet of materials, and complete and submit the evaluation form that will be sent to you via email. Please turn the attendance form into the ISPN Registration Desk before you leave the conference. The attendance form will serve as your contact hour certificate.

### Conflict of Interest

**Psychopharmacology Institute Pre-Conference and ISPN Annual Conference**  
**April 10-14, 2018**

The Wisconsin Nurses Association Continuing Education Approval Program requires that any speaker giving a presentation must disclose any significant financial interest or other relationship that they may have with the manufacturer(s) of any commercial products, service, technology, or program discussed at their educational presentation.

The Wisconsin Nurses Association Continuing Education Approval Program does not imply that any such financial interest or relationship is inherently improper or that such interest or relationship would prevent the speaker from making a presentation. It is imperative, however, that such financial interests or relationships be identified by the speaker so that participants have these facts fully disclosed prior to the presentation and may form their own judgments about the presentation.

Below is a listing of speakers with a conflict of interest:

Kathleen McCoy  
Consultant role for Avanir

Evelyn Parrish  
Speaker for Shire Pharmaceutical

The remaining speakers have reported no relationships with commercial companies.

### Non-Endorsement of Products

The presence of commercial exhibits during the conference does not imply endorsement by the ISPN, Wisconsin Nurses Association, or the American Nurses Credentialing Center's Commission on Accreditation.

20  
years

\* **Celebrating**  
\* **20 years**  
\* **in 2018**  
\*

\* International Society of  
\* Psychiatric-Mental Health Nurses  
\*

\* **ISPN**  
\*



The exhibit area will be located in the **Palm Ballroom C-F**. It will also be the site of the poster sessions and refreshment breaks during the Conference. Please plan time to stop by and visit with the exhibiting companies, which lend valuable financial support to the ISPN Conference.

Don't forget to complete and submit your Exhibitor Sign-Off sheet, found in your materials bag. You will be eligible to win a prize, brought to you by the Marketing and Development Committee.

**Open Hours:**

Wednesday, April 11	6:30 p.m.-8:00 p.m.
Thursday, April 12	7:30 a.m.-5:00 p.m.
Friday, April 13	7:00 a.m.-3:30 p.m.

**Allergan Pharmaceuticals ..... Booth #8**

5 Giralda Farms  
Madison, NJ 07940  
800-678-1605  
Email: Nikky.Peacock@Allergan.com  
Website: www.Allergan.com

Allergan is committed to working with physicians, healthcare providers and patients to deliver innovative and meaningful treatments that help people around the world live longer, healthier lives. Allergan markets a portfolio of leading brands and best-in-class products for the central nervous system, eye care, medical aesthetics and dermatology, gastroenterology, women's health, urology and anti-infective therapeutic categories.

**GeneSight ..... Booth #4**

6960 Cintas Blvd.  
Mason, Ohio 45040  
844-436-6306  
Email: info@assurexhealth.com  
Website: www.genesight.com

The GeneSight® test helps healthcare providers make better treatment decisions based on a person's genetic makeup. GeneSight testing is based on advanced CPGx® technology, a patented approach that analyzes variations and combinations of a person's genes along with FDA-approved medications for behavioral health conditions and chronic pain.

**Janssen ..... Booth #6**

1125 Bear Tavern Rd.  
Titusville, NJ 08560  
800-526-7726  
Email: jvasqu18@its.jnj.com  
Website: www.janssen.com

We collaborate with the world for the health of everyone in it. We at Janssen are entrusted with one of the most important jobs in the world. We aspire to transform lives by bringing life-saving and life-changing solutions to people who need them.

**McLean Hospital. .... Booth #1**

115 Mill Street  
Belmont, MA 02478  
Website: www.mcleanhospital.org

Top-ranked by U.S. News & World Report, McLean Hospital is the premier destination for psychiatric treatment, education, research, and advocacy. McLean offers unparalleled treatment services for children and adults living with conditions including depression, borderline personality disorder, OCD, and addiction.

**Otsuka America Pharmaceutical, Inc.****& Lundbeck ..... Booths #2 & #5**

508 Carnegie Center Drive  
Princeton, NJ 08540  
Phone: 609-524-6788  
Email: contact@otsuka-us.com

**OAPI**

Otsuka America Pharmaceutical, Inc. (OAPI), part of the Otsuka Group, is a fast-growing, innovative company with 25 years of experience in commercializing products developed by Otsuka, as well as in licensed products, focusing on a diverse portfolio of products in neuroscience, oncology and cardio-renal. For more information, visit us at <https://www.otsuka-us.com>

**Lundbeck**

Lundbeck is a global pharmaceutical company, specialized in psychiatric and neurological disorders. In the U.S., Lundbeck focuses solely on accelerating therapies for brain disorders, including epilepsy and actively engages in hundreds of initiatives each year that support our patient communities. For more information, visit us at <http://www.lundbeck.com/us>

**Pharmatechnology Inc. .... Booth #7**

161 West 21st Street  
New York, NY 10010  
Website: www.pharmatechnology.net

Pharmatechnology provides state of the art health care and innovations that treat all levels of the individual patient, mentally and physically.

**Sunovion Pharmaceuticals, Inc. .... Booth #9**

84 Waterford Drive  
Marlborough, MA 01752  
508-481-6700  
Website: www.sunovion.us

Sunovion Pharmaceuticals Inc., is a leading pharmaceutical company dedicated to discovering, developing, and commercializing therapeutic products that advance the science of medicine in the central nervous system and respiratory disease areas to improve the lives of patients and their families. Visit us online at [www.sunovion.com](http://www.sunovion.com).

**Taylor & Francis ..... Booth #3**

530 Walnut Street, Suite 850  
Philadelphia, PA 19106  
Phone: 215-625-8900  
Website: www.tandfonline.com

Taylor & Francis is a leading international publisher of scholarly research. We are proud to publish issues in Mental Health Nursing as a part of our medical portfolio of journals. Visit our booth to learn more about our products and services and to pick up free copies of our journals

## PROGRAM SCHEDULE: TUESDAY, APRIL 10

### Tuesday, April 10

11:00 a.m.-2:00 p.m.  
*Palm Ballroom Foyer*  
**Registration Open**

12:00 noon-12:15 p.m.  
*Palm Ballroom AD*  
**Welcome and Announcements**  
Debbie Thomas, EdD, PMHCNS-BC, PMHNP-BC,  
APRN, CMP



12:15 p.m.-1:45 p.m.  
*Palm Ballroom AD*  
**McCabe Lectureship**  
*Delirium Superimposed on Dementia:  
Treatment Challenges and Opportunities*  
Evelyn Parrish, PhD, APRN, PMHCNS-BC,  
PMHNP-BC  
**Funding for this presentation is possible, in  
part, through funds generously donated to the  
ISPN Foundation.**

1:55 p.m.-2:55 p.m.  
*Joshua Tree Room*  
**Concurrent Session 1.1**  
*Treatment of ADHD Across the Life Span:  
A Psychopharm Update*  
Geraldine Pearson, PhD, PMH-CNS, FAAN

*Xavier Room*  
**Concurrent Session 1.2**  
*Psychotropics During Pregnancy and Lactation*  
Lyons Hardy, CNS, NP  
Olivia Reichenbacker, PMHNP-DNP

3:05 p.m.-4:05 p.m.  
*Joshua Tree Room*  
**Concurrent Session 2.1**  
*Comorbid Alcohol and Other Drug Use and Cognitive  
Impairment: Challenges to Psychopharmacology*  
Adam Searby, PhD(c), RN

*Xavier Room*  
**Concurrent Session 2.2**  
*Effects of COMT Genotype on Treating ADHD: A Review of  
Current Literature*  
Joanna Johnson, MSN, APRN, PMHNP-BC

4:15 p.m.-5:15 p.m.  
*Palm Ballroom AD*  
**General Session**  
*Current Issues in Prescribing Controlled Substances: Curbside  
Consult (Facts, Fears, and Fallacies)*  
Debbie Thomas, EdD, PMHCNS-BC, PMHNP-BC,  
APRN, CMP  
Susan Krupnick, MSN, PMHCNS-BC, C-PREP

5:20 p.m.-6:20 p.m.  
*Joshua Tree Room*  
**Concurrent Session 3.1**  
*Identifying and Treating a Growing Concern: Intermittant  
Explosivity*  
Kathleen McCoy, DNSc, APRN, PMHNP-BC, PMHCNS-BC,  
FNP-BC, FAANP

*Xavier Room*  
**Concurrent Session 3.2**  
*The Role of Female Reproductive Hormones in Understanding  
and Treating Psychiatric Conditions Throughout the Life Span*  
Jessica Graham Steinhauer, PMHNP



## Wednesday, April 11

7:30 a.m.-7:00 p.m.

*Palm Ballroom Foyer*

**Registration Open**

7:30 a.m.-8:30 a.m.

*Palm Ballroom AD*

**Continental Breakfast**

8:30 a.m.-10:00 a.m.

*Palm Ballroom AD*

**Welcome and Announcements**

Debbie Thomas, EdD, PMHCNS-BC, PMHNP-BC,  
APRN, CMP



*Palm Ballroom AD*

**Plenary Session**

*Assessment and Treatment of Anxiety and  
Trauma Disorders: Influences of Culture and  
Immigration*

Barbara Peterson, PhD, PMHCNS-BC, RN

10:00 a.m.-11:50 a.m.

*Palm Ballroom BE*

**Symposium**

*Clinical Convergence<sup>SM</sup>: Optimizing the Diagnosis and  
Management of Pediatric Bipolar Disorder*

**Supported by an independent educational grant from  
Sunovion Pharmaceuticals Inc.**

11:50 a.m.-1:20 p.m.

*Palm Ballroom AD*

**Product Theater Luncheon**

*Explore an Option for Adult Patients With Schizophrenia  
Who May Need a Change in Treatment*

Georgia Stevens, PhD, APRN, PMHCNS-BC  
Director, P.A.L. Associates

**Sponsored by Otsuka America Pharmaceutical, Inc. &  
Lundbeck**

1:30 p.m.-2:30 p.m.

*Joshua Tree Room*

**Concurrent Session 4.1**

*Integrating Pharmacogenetics, Neurobiology, Family History,  
and Clinical Symptoms to Inform Psychopharmacology  
Decisions for a Difficult-to-Treat Adolescent*

Janiece DeSocio, PMHNP-BC, PhD, FAAN, RN

*Xavier Room*

**Concurrent Session 4.2**

*Advances in the Assessment and Treatment of Tardive  
Dyskinesia*

Susan Krupnick, MSN, PMHCNS-BC, C-PREP

2:40 p.m.-3:40 p.m.

*Joshua Tree Room*

**Concurrent Session 5.1**

*Prescribing Medications to Pregnant and/or  
Breastfeeding Women: Experiences Gained From  
Working in a Perinatal Mood Disorder Partial  
Hospitalization Program*

Robi Thomas, PhD, RN, PMHNP-BC

*Xavier Room*

**Concurrent Session 5.2**

*Searching for a Child's "Right" Medication: Tales of Frustration  
and Hope*

Barbara Johnson, PhD, RN, PMHNP

3:50 p.m.-5:00 p.m.

*Palm Ballroom AD*

**General Session**

*SPMI Panel to Represent Life Span*

Susan Krupnick, MSN, PMHCNS-BC, C-PREP

Anne Marie Jones, MSN, PMHNP-BC



5:05 p.m.-6:20 p.m.

*Palm Ballroom AD*

**Closing Plenary Session**

*Orthomolecular Psychiatry*

Michael Tremko, PMHNP

6:20 p.m.-6:30 p.m.

*Palm Ballroom AD*

**Complete Evaluations and Closing Remarks**

6:30 p.m.-8:00 p.m.

*Palm Ballroom CF*

**Annual Conference Opening Reception**

**Exhibits and Poster Session**

*All Psychopharmacology Institute  
Pre-Conference participants:  
Please join us for the Opening  
Reception celebrating  
the 20th Anniversary of ISPN!*

## ISPN MISSION AND PRACTICES

### MISSION:

To support advanced-practice psychiatric-mental health nurses in promoting mental health care, literacy, and policy worldwide.

### PRACTICES:

The practices of the International Society of Psychiatric-Mental Health Nurses are to:

- Strengthen the presence and voice of advanced practice psychiatric-mental health (PMH) nurses through contributions to standards, curricula, and public policy statements that promote equitable quality mental health care for individuals, families, and communities
- Promote advanced practice psychiatric nurses to deliver lifespan mental health care and literacy education to clients, families, and communities
- Promote members' research and the development of scholarship through funding, presentations, and publications
- Support members' efforts to collaborate with clients, families, communities, and national and international partners to address mental health issues
- Provide education, leadership development, and networking for members through conferences, online resources, service opportunities, and partnerships

## SAFETY RULES AND GUIDELINES

We welcome you to 11th annual Psychopharmacology Institute Pre-Conference. We know that you will find this to be an enriching and fulfilling experience. To ensure the safety and security of our attendees and guests, we have compiled the following list of safety rules and guidelines for this conference.

Tempe Mission Palms is committed to providing our guests a safe and secure stay. When a security or safety situation arises, or an incident occurs that should be brought to our attention, we ask that you observe the following reporting protocols:

- **For emergency aid of any kind, call 911** from any telephone outside of the hotel grounds.
- Review the fire safety procedures located on the door in your hotel room. Note the location of the fire exits in relation to your hotel room.
- Don't answer the door in your hotel room without verifying who it is. All hotel employees will identify themselves verbally and will have a hotel nametag. Please call the front desk or the operator if you are uncomfortable or uncertain.
- When returning to the hotel late in the evening, use the lobby entrance.
- Close the door securely whenever you are in your hotel room and use all of the locking devices provided.
- Secure all your valuables. Safe deposit boxes are available at the Front Desk.
- Do not leave any articles of value in your vehicle in the parking lot.
- When inside the conference venue, nametags should always be worn and visibly displayed. For security reasons, we recommend that you DO NOT wear your badge outside of the Tempe Mission Palms
- Please do not leave any bags, laptops or articles unsecured in any display area, meeting room, or public area. Personal items are most commonly left or lost in the restrooms. Please double-check the area before leaving the restrooms.
- Smoking is not permitted in the hotel. It is considered a smoke-free environment.
- Do not open any fire exit or other access door to any person. Access to the conference is strictly for members and registered conference guests. All access to display areas, meetings, and symposia is through the appropriate entrance doors. All fire exits are alarmed.
- If you note any suspicious article, packages, persons, or activity please contact the event staff or the front desk immediately.
- Do not give your lodging information to any person.

In the event of an alarm, follow the following directions:

- Proceed carefully to the nearest exit. Emergency evacuation routes are located on the back of every guestroom door. All public space areas are clearly marked with Exit signs.
- Use the stairwells to evacuate the building. Do not attempt to use the elevators.
- Any guest requiring assistance during an evacuation should dial "0" and notify the operator of their location.

During an alarm, announcements will be made over the PA system informing guests to evacuate. For further information, read the security section of your in-room guest directory.





## ISPN WOULD LIKE TO THANK ITS 2018 ANNUAL CONFERENCE SPONSORS AND EXHIBITORS!

### Platinum



### Silver



**McLean HOSPITAL**  
HARVARD MEDICAL SCHOOL AFFILIATE

### Bronze



AUGUSTA UNIVERSITY  
**COLLEGE OF NURSING**



**GLOBAL ALLIANCE**  
for Behavioral Health and Social Justice



OPTIMIZING THE DIAGNOSIS  
AND MANAGEMENT OF **PEDIATRIC**

# BIPOLAR DEPRESSION



Postgraduate Institute  
for Medicine

Jointly provided by RMEI Medical Education, LLC  
and Postgraduate Institute for Medicine.

This activity is supported by an independent  
medical educational grant from Sunovion.

# HOTEL FLOOR PLANS: TEMPE MISSION PALMS HOTEL

## First Floor

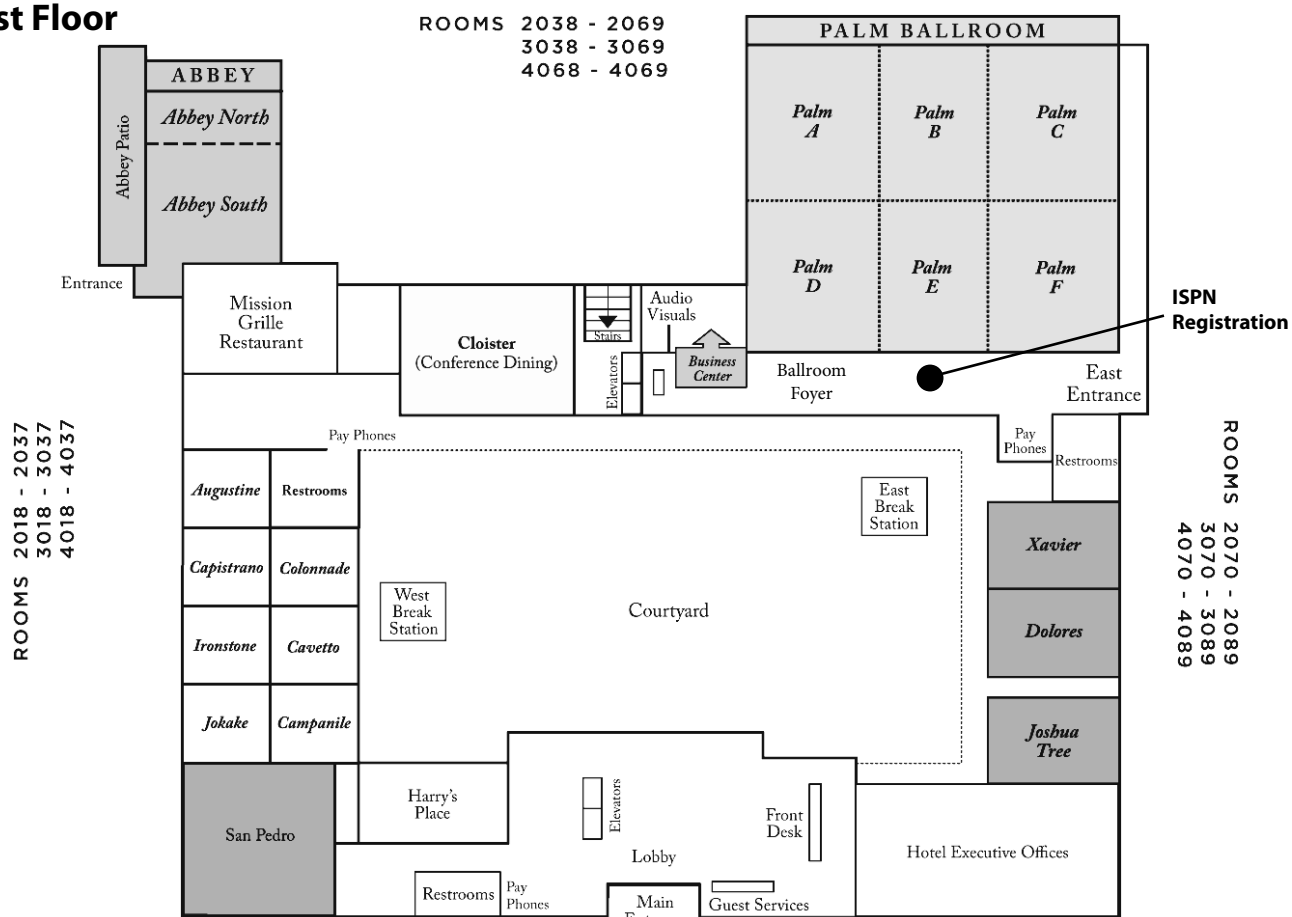

## Second Floor

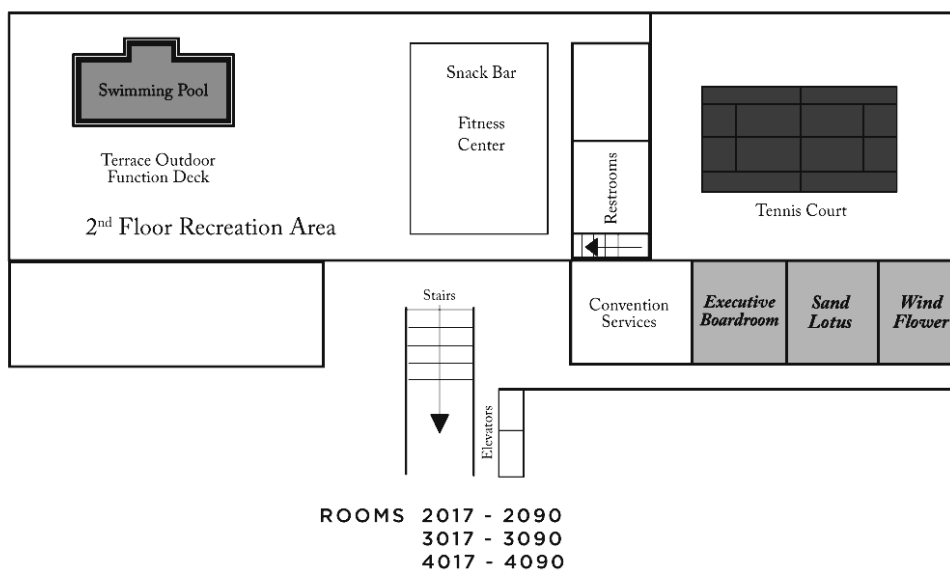

**Learn More About an Important Topic in Psychiatric Care: Attend Our Product Theater at the 2018 ISPN 11th Annual Psychopharmacology Institute and 20th Annual Conference!**

# Explore a Treatment Option for Adult Patients With Schizophrenia

**Wednesday, April 11, 2018 11:50AM-1:20PM**

*Lunch will be provided.*

**Tempe Mission Palms Hotel and Conference Center**

Palm Ballroom AD  
60 E. 5th Street, Tempe, Arizona

**Georgia Stevens, PhD, APRN, PMHCNS-BC**

Director, P.A.L. Associates:  
Partners in Aging & Long-Term Caregiving  
Washington, DC  
LTC Educator & Care Consultant, BHSBaltimore  
Baltimore, Maryland



Dr. Stevens is a paid consultant of Otsuka America Pharmaceutical, Inc. and Lundbeck.

**The intended audience for this product theater is healthcare professionals involved in the treatment of patients with schizophrenia.**

This program is sponsored by Otsuka America Pharmaceutical, Inc. and Lundbeck.

In accordance with the PhRMA Code on Interactions with Healthcare Professionals, attendance at this educational program is limited to only healthcare professionals (HCPs) (physicians, nurse practitioners, physician assistants, registered nurses, clinical pharmacists, and social workers). Accordingly, attendance by guests or spouses is not permitted. No continuing medical education (CME) credits are offered for this program. This program may include the provision of a modest meal. Otsuka does not offer such a meal to HCPs whose institutions prohibit such hospitality, nor does Otsuka offer a meal where federal or state laws (e.g., Vermont and Minnesota) limit an HCP's ability to accept such a meal.

Accordingly, please consult your legal or ethics advisor regarding any applicable limitation before attending this program. If you are licensed to practice in a state where meals are either prohibited and/or restricted and you accept a meal, you understand that you will be required to reimburse Otsuka for the cost of this meal. Please note that Otsuka is required to report the value of a provided meal pursuant to applicable federal and/or state laws.

©2018 Otsuka America Pharmaceutical, Inc.

February 2018 11US18EUP0001

## IN PLAIN VIEW

**INJECTING A MAINTENANCE TREATMENT INTO THE BIPOLAR I DISORDER CONVERSATION**

*Model portrayal.*

**Attend our Product Theater featuring**

Melissa Frost, MSN, GNP, APRN-BC  
Psychiatric Mental Health Nurse Practitioner  
Frost Mental Healthcare  
Glendora, California

**Thursday, April 12, 2018  
12:25PM-1:40PM Mountain**

**Location**

Palm Ballroom ABDE  
Tempe Mission Palms Hotel  
and Conference Center  
Tempe, Arizona

Melissa Frost, MSN, GNP, APRN-BC, is a paid consultant for Otsuka America Pharmaceutical, Inc. and Lundbeck.

**The intended audience for this program is appropriate healthcare professionals.**

**This program is sponsored by Otsuka America Pharmaceutical, Inc. and Lundbeck LLC and is not a CME activity.**

This is a promotional program and no CME credits are offered. This educational program may include the provision of a modest meal. Otsuka and Lundbeck do not offer such a meal to healthcare professionals (HCPs) whose institutions prohibit such hospitality, nor do Otsuka and Lundbeck offer a meal where federal or state laws (e.g., Vermont and Minnesota) limit an HCP's ability to accept such a meal. Accordingly, please consult your legal or ethics advisor regarding any applicable limitation before attending this educational program. If you are licensed to practice in a state where meals are either prohibited and/or restricted and you accept a meal, you understand that you will be required to reimburse Otsuka for the cost of this meal.

Please note that Otsuka and Lundbeck are required to report the value of a provided meal pursuant to applicable federal and/or state laws.

In accordance with the PhRMA Code on Interactions with Healthcare Professionals, attendance at this educational program is limited to only healthcare professionals (physicians, nurse practitioners, physician assistants, RNs, clinical pharmacists, social workers). Accordingly, attendance by guests or spouses is not permitted.

©2018 Otsuka America Pharmaceutical, Inc.  
January 2018 09US18EUP0005

ALLERGAN PRESENTS

**AN ATYPICAL  
ANTIPSYCHOTIC  
TREATMENT FOR  
BIPOLAR MANIA AND  
SCHIZOPHRENIA:  
A CLINICAL  
OVERVIEW**



Allergan® and its design are trademarks of Allergan, Inc.  
© 2018 Allergan. All rights reserved.  
UNB114038 03/18

FEATURING:

**Davika Mattox,**  
MSN, APRN-PMHNP-BC

**Friday, April 13, 2018**  
**12:00 pm–1:00 pm**  
PALM BALLROOM

**EXPERIENCE OUR  
SCHIZOPHRENIA SIMULATOR  
AT THE ALLERGAN BOOTH #8**



**Sunovion Pharmaceuticals Inc.**  
**is dedicated to developing new**  
**treatment options for patients**  
**living with mental illness.**

[www.Sunovion.com](http://www.Sunovion.com)

SUNOVION and  are registered trademarks of Sumitomo Dainippon Pharma Co., Ltd.  
Sunovion Pharmaceuticals Inc. is a U.S. subsidiary of Sumitomo Dainippon Pharma Co., Ltd.  
© 2017 Sunovion Pharmaceuticals Inc. All rights reserved. 5/17 LAT617-17

